

HYDRAULIC BOTTLE JACKS**LARZEP advantages**

- From 2 to 50 Tn.
- Up to 30Tn 'A' Models are single stage with screw extension.
- 20Tn and 30Tn 'AC' versions are supplied with pressure gauge, calibrated to read in tonnes with $\pm 1,6\%$ accuracy.
- 'AB' versions are telescopic with two hydraulic extensions.
- All models with safety relief valve.
- Forged material base.
- Supplied with zinc plated handle and individual cardboard box.
- Bottle jacks will operate horizontally, provided that the pump element is at the lowest point.

Carefully read and understand the safety instructions.





Bottle jack with lock nut



50 Tn, 2 speed,
long stroke bottle jack

HYDRAULIC BOTTLE JACKS

A-AB-AC

2-50 Tn.

700 bar

AUTOMOTIVE

Larzep designs and manufactures special jacks, upon request.



BOTTLE JACKS - A

Capacity	Model	A	B	C	D	Screw E	Weight
Tn	LARZEP	mm	mm	mm	mm	mm	kg
2	A40211	172	372	112	103x105	88	3,9
3	A40311	172	372	112	103x105	88	3,9
5	A40515	212	468	146	110x112	110	5,0
8	A40815	220	483	148	124x127	115	7,5
10	A41015	220	483	148	124x127	115	7,5
15	A41515	231	498	154	140x142	113	10,1
20	A22014	214	421	142	160x168	65	8,5
30	A23014	222	429	142	154x164	65	11,0
50	A25014	216	361	145	180x190	-	19,9

A-AC

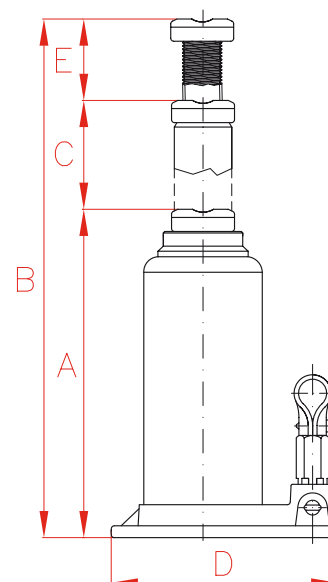

AB

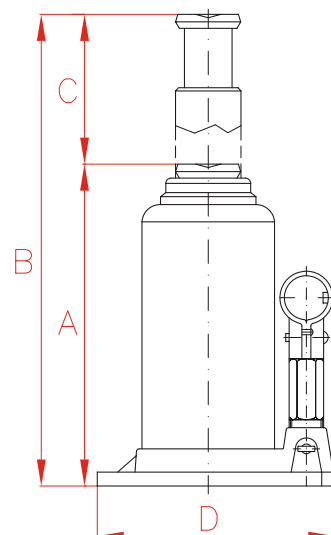

BOTTLE JACKS WITH PRESSURE GAUGE - AC

Capacity	Model	A	B	C	D	Screw E	Weight
Tn	LARZEP	mm	mm	mm	mm	mm	kg
20	AC22014	214	421	142	160x168	65	8,7
30	AC23014	222	429	142	154x164	65	11,2

TELESCOPIC BOTTLE JACKS - AB

Capacity	Model	A	B	C	D	Weight
Tn	LARZEP	mm	mm	mm	mm	kg
4	AB40434	265	610	345	124 x 128	7,5
10	AB21027	249	519	270	154 x 164	13,0