



**Norbar Torque Tools**

## **TT Screwdriver**

TTs1.5 to TTs6.0 (N·m)

TTs13 to TTs53 (lbf·in)

## Adjustable Type

- Unlock
- Déverrouiller la mollette
- Entsichern
- Sbloccare
- Desbloquear

- Lock
- Verrouiller la molette
- Sichern
- Bloccare
- Bloquear

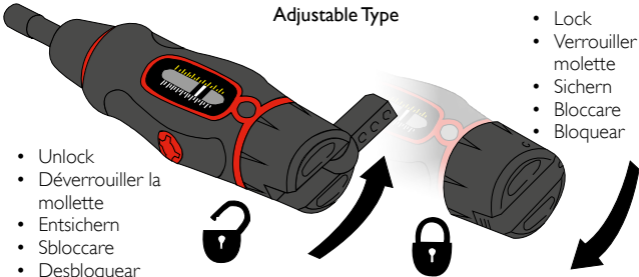

## Adjustable Type

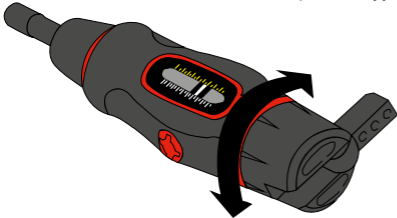

- Turn knob to adjust
- Tournez le pommeau pour régler
- Zur Einstellung des gewünschten Wertes, betätigen Sie den Drehknopf am Ende des Handgriffes
- Ruotare il pomello di regolazione
- Ajuste el par girando extremo

## Adjustable Type



## Adjustable Type

- Never adjust beyond the marked scale
- Ne jamais régler en-dehors de la zone de l'échelle
- Niemals über den markierten Skalenbereich hinaus einstellen
- Mai regolare la chiave oltre il marchio sulla scala
- No ajustar por debajo de la zona marcada en la escala

P Type

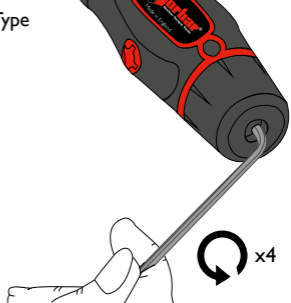
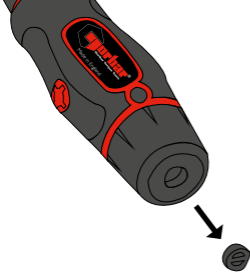

## P Type

- Remove Seal and loosen locking screw
- Ôter la protection et desserrer la vis de blocage
- Das Siegel entfernen und die Schraube lösen
- Rimuovere la guarnizione e allentare la vite di bloccaggio
- Quite el tapón y afloje el tornillo de bloqueo

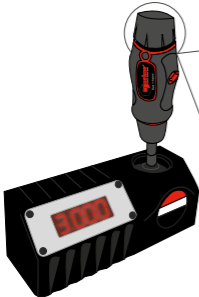

P Type

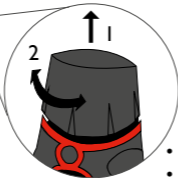

- Adjust - Operate - Check
- Ajuster - Manoeuvrer - Contrôler
- Einstellen - Bedienen - Prüfen
- Regolare - Azionare - Verificare
- Ajuste - Apriete - Verifique



P Type

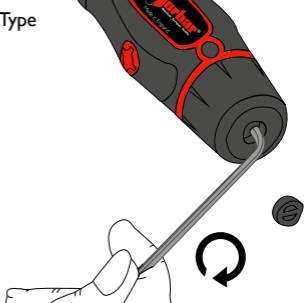

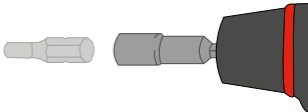
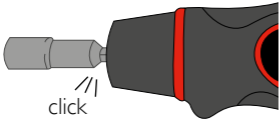
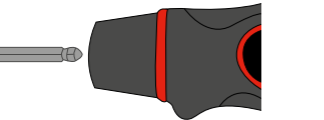



- Rotate tool until slip.
- Appliquer le couple par rotation jusqu'au déclenchement
- Anziehen mit dem Drehmomentschrauber, bis dieser auslöst
- Ruotare l'attrezzo fino allo slittamento
- Gire la herramienta hasta que sienta el embrague



View our How to Use Video at  
[www.norbar.com/HowToUseATorqueScrewdriver](http://www.norbar.com/HowToUseATorqueScrewdriver)

[www.norbar.com](http://www.norbar.com)

Norbar Torque Tools Ltd  
Beaumont Road, Banbury, OX16 1XJ

Part No. 34405 Issue 1  
© Norbar Torque Tools Ltd 2013